



**MODEL 9650 FIXED WINDOW,
IMPACT RESISTANT,
FLANGE, EQUAL-LEG & FIN FRAMES**

DP RATING SEE TABLES A-I	LARGE & SMALL MISSILE IMPACT RESISTANT
-----------------------------	--



A. LYNN MILLER, P.E., P.E.# 58705

1) THIS PRODUCT HAS BEEN DESIGNED & TESTED TO COMPLY WITH THE REQUIREMENTS OF THE FLORIDA BUILDING CODE, EXCLUDING THE HIGH VELOCITY HURRICANE ZONE (HVHZ).

2) SHUTTERS ARE NOT REQUIRED WHEN USED IN WIND-BORNE DEBRIS REGIONS.

3) MASONRY ANCHORS MAY BE USED INTO WOOD. ALL WOOD BUCKS LESS THAN 1-1/2" THICK ARE TO BE CONSIDERED 1X INSTALLATIONS. 1X WOOD BUCKS ARE OPTIONAL IF UNIT IS INSTALLED DIRECTLY TO SUBSTRATE. WOOD BUCKS DEPICTED AS 2X ARE 1-1/2" THICK OR GREATER.

4) ANCHOR EMBEDMENT TO BASE MATERIAL SHALL BE BEYOND WALL DRESSING OR STUCCO. USE ANCHORS OF SUFFICIENT LENGTH.

5) MAX. 1/4" SHIMS ARE REQUIRED AT EACH ANCHOR LOCATION WHERE THE PRODUCT IS NOT FLUSH TO THE SUBSTRATE. USE SHIMS CAPABLE OF TRANSFERRING APPLIED LOADS.

6) THE ANCHORAGE METHODS SHOWN HAVE BEEN DESIGNED TO RESIST THE WIND LOADS CORRESPONDING TO THE REQUIRED DESIGN PRESSURE. THE 33-1/3% STRESS INCREASE HAS NOT BEEN USED IN THE DESIGN OF THIS PRODUCT. THE 1.6 LOAD DURATION FACTOR WAS USED FOR THE EVALUATION OF ANCHORS INTO WOOD. ANCHORS THAT COME INTO CONTACT WITH OTHER DISSIMILAR MATERIALS SHALL MEET THE REQUIREMENTS OF THE FLORIDA BUILDING CODE FOR CORROSION RESISTANCE.

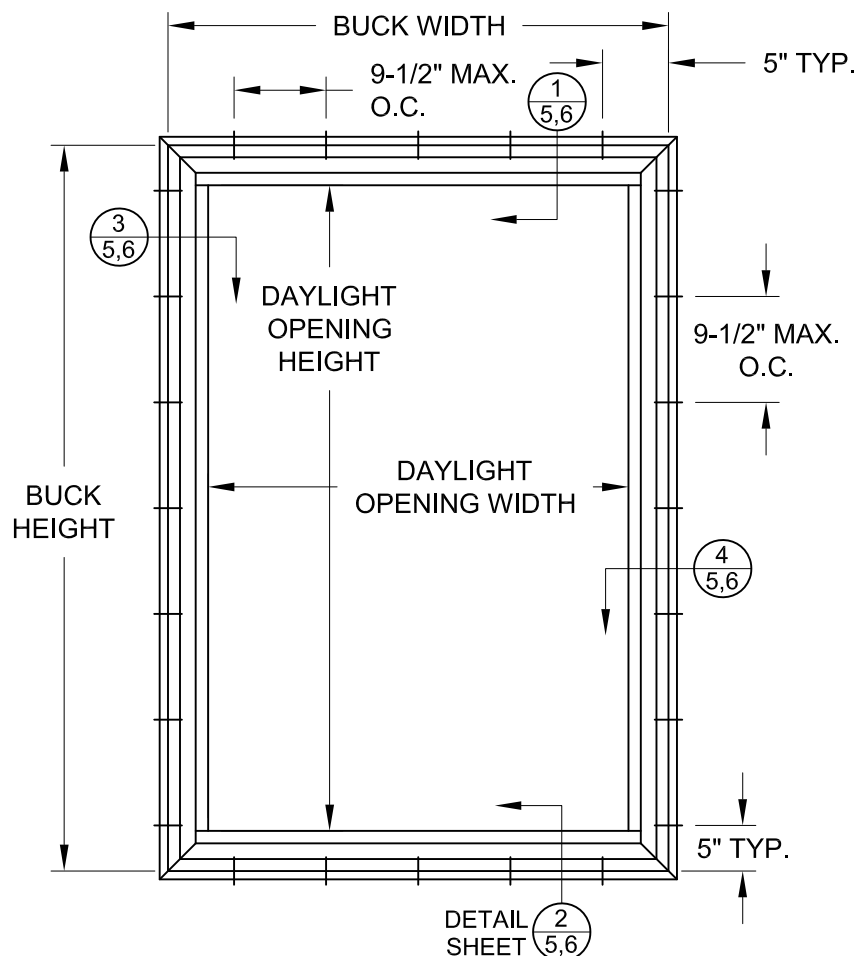

**TYP. ANCHOR LOCATIONS
(FLANGED FRAME, EQUAL-LEG SIM.)**
SEE TABLES A-I FOR SIZES

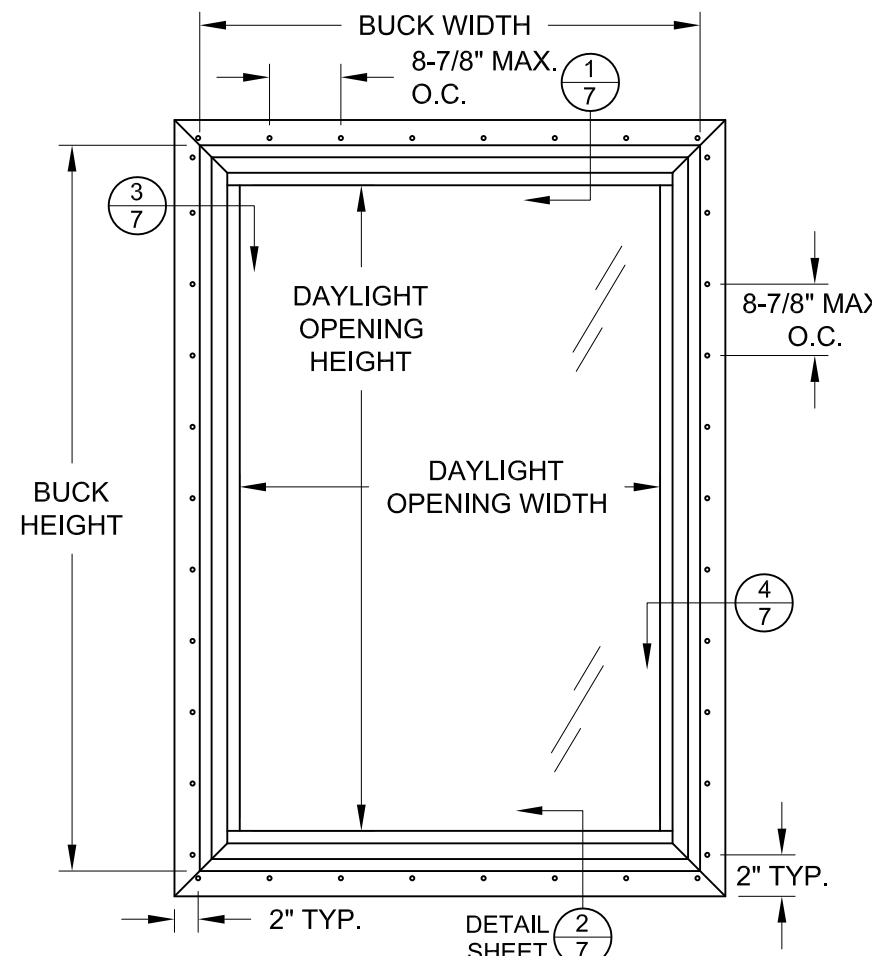

**TYP. ANCHOR LOCATIONS
(INTEGRAL FIN FRAME)**
SEE TABLES A-I FOR SIZES

SHAPES AS SHOW BELOW, OR SIMILAR MAY BE USED BY INSCRIBING THE SHAPE IN A BLOCK AND OBTAINING DESIGN PRESSURES FOR THAT BLOCK SIZE FROM THE TABLES ON SHEETS 2-7.

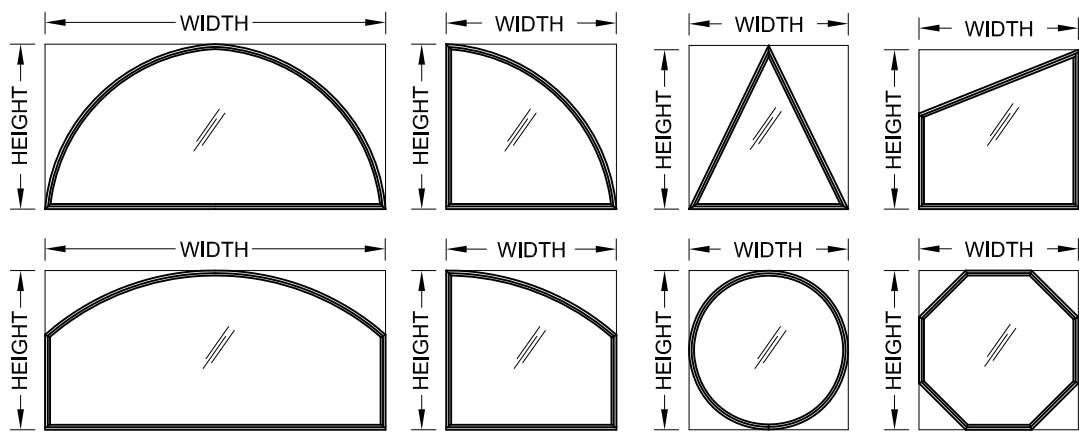

DAYLIGHT OPENING WIDTH = BUCK WIDTH - 4.25
DAYLIGHT OPENING HEIGHT = BUCK HEIGHT - 4.25

REGISTRATION #29296
COPYRIGHT © 2022
NEWSOUTH WINDOW SOLUTIONS
LIMITED LICENSE TO MAKE
COPIES FOR PERMITTING

PREPARED BY: A. LYNN MILLER, P.E.
1070 TECHNOLOGY DR
N. VENICE, FL 34275
(941)-480-1600

BY:	FIXED WINDOW FPA, LM
	GEN. NOTES AND ANCHOR ELEVATIONS
REVISION:	REVISE SILICONE & ANCHOR OPTIONS, AND DP TABLES
	CORRECT TYPO, TABLE I HEADER, ADD SHAPES, ADD SILICONE 995.
DATE:	11/28/22
DATE:	08/16/23
#:	B
#:	C
DATE: 02/01/23	
SCALE: NTS	
BY: S.BERKOWITZ	
DRAWING #: PW9650-FPA-01	
SHEET: 1 OF 11	

TABLE A:

Window Design Pressure (+/- psf)																						
Glass Type 1: 7/8" LIG: (1/8" A - AIRSPACE - 5/16" A/A .090" PVB)																						
WINDOW DIMENSIONS	Long Side (in.)																					
	48	50	52	54	56	58	60	62	64	66	68	70	72	74	76	78	80	82	84			
Short Side (in.)	18	70.0	70.0	70.0	70.0	70.0	70.0	70.0	70.0	70.0	70.0	70.0	70.0	70.0	70.0	70.0	70.0	70.0	70.0	70.0		
	20	70.0	70.0	70.0	70.0	70.0	70.0	70.0	70.0	70.0	70.0	70.0	70.0	70.0	70.0	70.0	70.0	70.0	70.0	70.0	70.0	
	22	70.0	70.0	70.0	70.0	70.0	70.0	70.0	70.0	70.0	70.0	70.0	70.0	70.0	70.0	70.0	70.0	70.0	70.0	70.0	70.0	
	24	70.0	70.0	70.0	70.0	70.0	70.0	70.0	70.0	70.0	70.0	70.0	70.0	70.0	70.0	70.0	70.0	70.0	70.0	70.0	70.0	
	26	70.0	70.0	70.0	70.0	70.0	70.0	70.0	70.0	70.0	70.0	70.0	70.0	70.0	70.0	70.0	70.0	70.0	70.0	69.6	68.2	
	28	70.0	70.0	70.0	70.0	70.0	70.0	70.0	70.0	70.0	70.0	70.0	70.0	69.0	66.9	65.2	64.1	63.0	62.1	61.3		
	30	70.0	70.0	70.0	70.0	70.0	70.0	70.0	70.0	70.0	70.0	70.0	68.2	65.0	63.3	62.0	60.8	59.6	58.4	57.4	56.3	
	32	70.0	70.0	70.0	70.0	70.0	70.0	70.0	70.0	70.0	67.8	64.6	62.4	60.6	58.7	57.0	55.7	54.5				
	34	70.0	70.0	70.0	70.0	70.0	70.0	70.0	70.0	67.9	64.8	62.6	60.8	58.8	56.9	54.9						
	36	70.0	70.0	70.0	70.0	70.0	70.0	70.0	67.3	64.5	62.7	61.1	59.3	57.4								
	38	70.0	70.0	70.0	70.0	70.0	70.0	67.2	64.4	62.5	60.9	59.2										
	40	70.0	70.0	70.0	70.0	70.0	67.6	64.6	62.7	60.9												
	42	70.0	70.0	70.0	70.0	68.2	65.0	62.9														
	44	70.0	70.0	70.0	69.2	65.8	63.3															
	46	70.0	70.0	70.0	67.2	64.0																
48	70.0	70.0	68.8	65.2																		

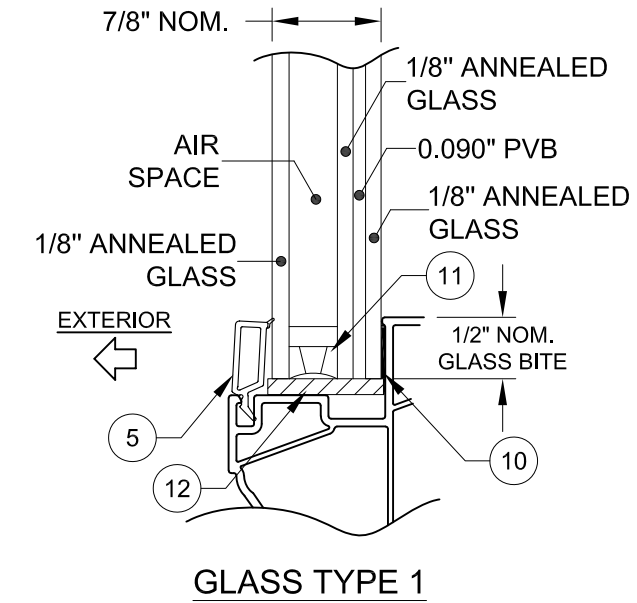
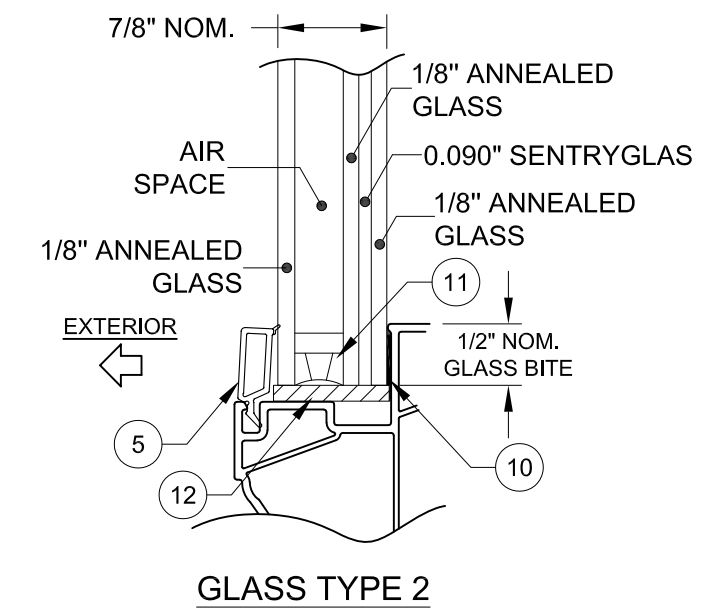

TABLE B:

Window Design Pressure (+/- psf)																					
Glass Type 2: 7/8" LIG: (1/8" A - AIRSPACE - 5/16" A/A .090" SG)																					
WINDOW DIMENSIONS	Long Side (in.)																				
	62	64	66	68	70	72	74	76	78	80	82	84	86	88	90	92	94	96	98		
Short Side (in.)	32	60.0	60.0	60.0	60.0	60.0	60.0	60.0	60.0	60.0	60.0	60.0	60.0	60.0	60.0	60.0	60.0	60.0	60.0	60.0	
	34	60.0	60.0	60.0	60.0	60.0	60.0	60.0	60.0	60.0	60.0	60.0	60.0	60.0	60.0	60.0	60.0	60.0	60.0	60.0	60.0
	36	60.0	60.0	60.0	60.0	60.0	60.0	60.0	60.0	60.0	60.0	60.0	60.0	60.0	60.0	59.2	58.4	57.6	56.9		
	38	60.0	60.0	60.0	60.0	60.0	60.0	60.0	60.0	60.0	60.0	60.0	60.0	60.0	58.7	57.4	56.3	55.5	54.7	53.9	
	40	60.0	60.0	60.0	60.0	60.0	60.0	60.0	60.0	60.0	60.0	60.0	59.6	58.1	56.7	55.2	53.8	52.8	51.9	51.1	
	42	60.0	60.0	60.0	60.0	60.0	60.0	60.0	60.0	60.0	60.0	59.4	57.9	56.3	54.8	53.4	52.3	51.2	50.2	49.1	
	44	60.0	60.0	60.0	60.0	60.0	60.0	60.0	59.8	58.6	57.4	56.1	54.7	53.2	52.0	50.9	49.8	48.7	47.6		
	46	60.0	60.0	60.0	60.0	60.0	60.0	60.0	59.1	57.8	56.5	55.2	53.9	52.9	51.8	50.8	49.6	48.4	47.3	46.2	
	48	60.0	60.0	60.0	60.0	60.0	60.0	58.7	57.3	55.9	54.6	53.3	52.2	51.2	50.2	49.2	48.2	47.2	46.0	44.8	
	50	60.0	60.0	60.0	60.0	59.4	58.3	57.0	55.6	54.1	52.9	51.7	50.6	49.6	48.6	47.5	46.5	45.6	44.6	43.5	
	52	60.0	60.0	60.0	58.7	57.4	56.1	55.0	53.8	52.7	51.4	50.3	49.1	48.0	46.9	45.9	44.9	43.8	43.0		
	54	60.0	59.6	58.1	56.7	55.3	54.1	53.0	52.0	51.1	50.1	48.9	47.7	46.5	45.4	44.3	43.2				
	56	59.4	57.7	56.2	54.7	53.4	52.3	51.2	50.3	49.3	48.4	47.4	46.3	45.1	43.9	42.8					
	58	57.6	55.9	54.3	53.0	51.8	50.7	49.6	48.6	47.6	46.6	45.6	44.7	43.7							
	60	55.9	54.1	52.7	51.5	50.3	49.2	48.0	47.0	45.9	44.9	43.9	43.0								
62	54.1	52.6	51.3	50.1	48.9	47.7	46.5	45.4	44.3	43.2											



NOTES: 1) FOR SIZES NOT SHOWN, ROUND UP TO THE NEXT AVAILABLE WIDTH OR HEIGHT DIMENSION.



REGISTRATION #29296
 COPYRIGHT © 2022
 NEWSOUTH WINDOW SOLUTIONS
 LIMITED LICENSE TO MAKE
 COPIES FOR PERMITTING

PREPARED BY: A. LYNN MILLER, P.E.
 1070 TECHNOLOGY DR
 N. VENICE, FL 34275
 (941)-480-1600

FIXED WINDOW FPA, LM
 DP TABLES & GLASS TYPES
 NEWSOUTH WINDOW SOLUTIONS
 10741 CROSSROADS COMMERCE BLVD.
 TAMPA, FL 33610

REVISION: REVISE SILICONE & ANCHOR OPTIONS, AND DP TABLES
 CORRECT TYPO, TABLE I HEADER, ADD SHAPES, ADD SILICONE 995.

DATE: 11/28/22
 08/16/23

#: B C

DATE: 02/01/23
 SCALE: NTS
 BY: S.BERKOWITZ
 DRAWING #: PW9650-FPA-01
 SHEET: 2 OF 11

A. LYNN MILLER, P.E., P.E.# 58705

TABLE C:

Window Design Pressure (+/- psf)																					
Glass Type 3: 7/8" LIG: (1/8" T - AIRSPACE - 5/16" A/A .090" PVB)																					
WINDOW DIMENSIONS	Long Side (in.)																				
	48	50	52	54	56	58	60	62	64	66	68	70	72	74	76	78	80	82	84		
Short Side (in.)	18	70.0	70.0	70.0	70.0	70.0	70.0	70.0	70.0	70.0	70.0	70.0	70.0	70.0	70.0	70.0	70.0	70.0	70.0	70.0	
	20	70.0	70.0	70.0	70.0	70.0	70.0	70.0	70.0	70.0	70.0	70.0	70.0	70.0	70.0	70.0	70.0	70.0	70.0	70.0	70.0
	22	70.0	70.0	70.0	70.0	70.0	70.0	70.0	70.0	70.0	70.0	70.0	70.0	70.0	70.0	70.0	70.0	70.0	70.0	70.0	70.0
	24	70.0	70.0	70.0	70.0	70.0	70.0	70.0	70.0	70.0	70.0	70.0	70.0	70.0	70.0	70.0	70.0	70.0	70.0	70.0	70.0
	26	70.0	70.0	70.0	70.0	70.0	70.0	70.0	70.0	70.0	70.0	70.0	70.0	70.0	70.0	70.0	70.0	70.0	70.0	70.0	70.0
	28	70.0	70.0	70.0	70.0	70.0	70.0	70.0	70.0	70.0	70.0	70.0	70.0	70.0	70.0	70.0	70.0	70.0	70.0	69.0	68.1
	30	70.0	70.0	70.0	70.0	70.0	70.0	70.0	70.0	70.0	70.0	70.0	70.0	70.0	68.9	67.5	66.2	64.9	63.8	62.6	
	32	70.0	70.0	70.0	70.0	70.0	70.0	70.0	70.0	70.0	70.0	70.0	69.4	67.3	65.2	63.3	61.9	60.6			
	34	70.0	70.0	70.0	70.0	70.0	70.0	70.0	70.0	70.0	70.0	69.6	67.5	65.4	63.2	61.0					
	36	70.0	70.0	70.0	70.0	70.0	70.0	70.0	70.0	70.0	69.7	67.8	65.9	63.7							
	38	70.0	70.0	70.0	70.0	70.0	70.0	70.0	70.0	69.5	67.6	65.8									
	40	70.0	70.0	70.0	70.0	70.0	70.0	70.0	69.6	67.6											
	42	70.0	70.0	70.0	70.0	70.0	70.0	69.2													
	44	70.0	70.0	70.0	70.0	70.0	69.2														
	46	70.0	70.0	70.0	70.0	69.7															
48	70.0	70.0	70.0	70.0																	

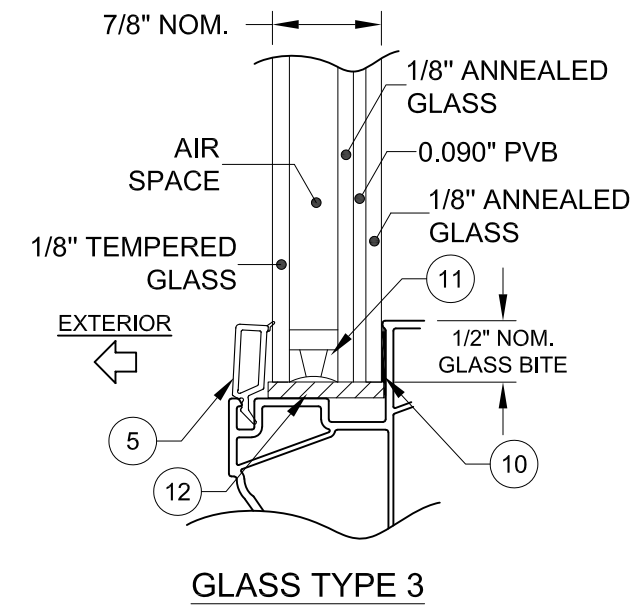
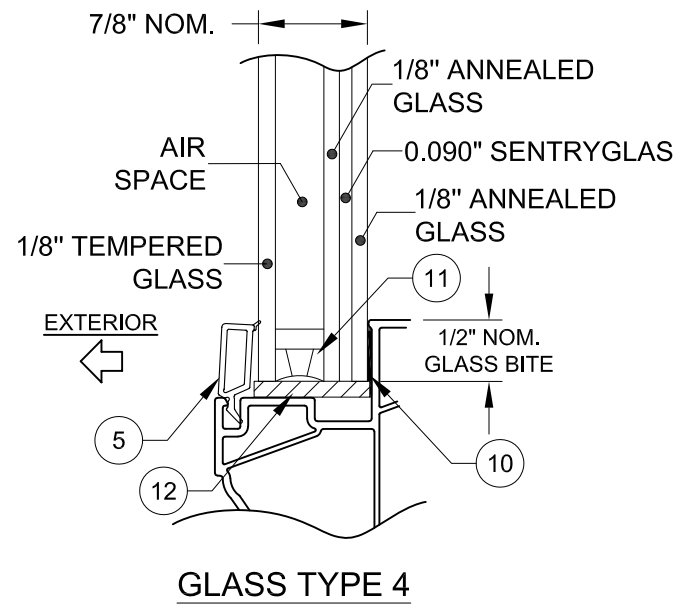

TABLE D:

Window Design Pressure (+/- psf)																					
Glass Type 4: 7/8" LIG: (1/8" T - AIRSPACE - 5/16" A/A .090" SG)																					
WINDOW DIMENSIONS	Long Side (in.)																				
	62	64	66	68	70	72	74	76	78	80	82	84	86	88	90	92	94	96	98		
Short Side (in.)	32	60.0	60.0	60.0	60.0	60.0	60.0	60.0	60.0	60.0	60.0	60.0	60.0	60.0	60.0	60.0	60.0	60.0	60.0	60.0	
	34	60.0	60.0	60.0	60.0	60.0	60.0	60.0	60.0	60.0	60.0	60.0	60.0	60.0	60.0	60.0	60.0	60.0	60.0	60.0	60.0
	36	60.0	60.0	60.0	60.0	60.0	60.0	60.0	60.0	60.0	60.0	60.0	60.0	60.0	60.0	60.0	60.0	60.0	60.0	60.0	60.0
	38	60.0	60.0	60.0	60.0	60.0	60.0	60.0	60.0	60.0	60.0	60.0	60.0	60.0	60.0	60.0	60.0	60.0	60.0	60.0	59.9
	40	60.0	60.0	60.0	60.0	60.0	60.0	60.0	60.0	60.0	60.0	60.0	60.0	60.0	60.0	60.0	59.8	58.6	57.6	56.8	
	42	60.0	60.0	60.0	60.0	60.0	60.0	60.0	60.0	60.0	60.0	60.0	60.0	60.0	60.0	59.3	58.1	56.9	55.7	54.5	
	44	60.0	60.0	60.0	60.0	60.0	60.0	60.0	60.0	60.0	60.0	60.0	60.0	60.0	59.2	57.8	56.6	55.3	54.1	52.9	
	46	60.0	60.0	60.0	60.0	60.0	60.0	60.0	60.0	60.0	60.0	59.9	58.7	57.6	56.4	55.1	53.8	52.6	51.3		
	48	60.0	60.0	60.0	60.0	60.0	60.0	60.0	60.0	60.0	60.0	59.2	58.0	56.9	55.8	54.7	53.6	52.4	51.1	49.8	
	50	60.0	60.0	60.0	60.0	60.0	60.0	60.0	60.0	60.0	58.7	57.5	56.3	55.1	54.0	52.8	51.7	50.6	49.6	48.3	
	52	60.0	60.0	60.0	60.0	60.0	60.0	59.8	58.5	57.1	55.9	54.6	53.4	52.1	51.0	49.8	48.7	47.7			
	54	60.0	60.0	60.0	60.0	60.0	58.9	57.8	56.8	55.6	54.3	52.9	51.7	50.4	49.2	48.0					
	56	60.0	60.0	60.0	60.0	59.3	58.1	56.9	55.9	54.8	53.7	52.7	51.4	50.1	48.8	47.6					
	58	60.0	60.0	60.0	58.8	57.6	56.3	55.1	54.0	52.8	51.8	50.7	49.6	48.5							
	60	60.0	60.0	58.5	57.2	55.9	54.6	53.4	52.2	51.0	49.8	48.7	47.8								
62	60.0	58.5	57.0	55.7	54.3	52.9	51.7	50.4	49.3	48.0											



NOTES: 1) FOR SIZES NOT SHOWN, ROUND UP TO THE NEXT AVAILABLE WIDTH OR HEIGHT DIMENSION.



REGISTRATION #29296
 COPYRIGHT © 2022
 NEWSOUTH WINDOW SOLUTIONS
 LIMITED LICENSE TO MAKE
 COPIES FOR PERMITTING

PREPARED BY: A. LYNN MILLER, P.E.
 1070 TECHNOLOGY DR
 N. VENICE, FL 34275
 (941)-480-1600

BY:	FIXED WINDOW FPA, LM
REVISION:	REVISE SILICONE & ANCHOR OPTIONS, AND DP TABLES
DATE:	11/28/22
#:	B C
DATE:	02/01/23
SCALE:	NTS
BY:	S. BERKOWITZ
DRAWING #:	PW9650-FPA-01
SHEET:	3 OF 11

DP TABLES & GLASS TYPES
 NEWSOUTH WINDOW SOLUTIONS
 10741 CROSSROADS COMMERCE BLVD.
 TAMPA, FL 33610

A. LYNN MILLER, P.E., P.E.# 58705



A. LYNN MILLER, P.E., P.E.# 58705

REGISTRATION #29296
 COPYRIGHT © 2022
 NEWSOUTH WINDOW SOLUTIONS
 LIMITED LICENSE TO MAKE
 COPIES FOR PERMITTING

PREPARED BY: A. LYNN MILLER, P.E.
 1070 TECHNOLOGY DR
 N. VENICE, FL 34275
 (941)-480-1600

BY: FIXED WINDOW FPA, LM
 SB
 SB

REVISION: REVISE SILICONE & ANCHOR
 OPTIONS, AND DP TABLES
 CORRECT TYPO, TABLE I HEADER, ADD
 SHAPES, ADD SILICONE 995.

DATE: 11/28/22
 08/16/23

#: B C

DATE: 02/01/23
 SCALE: NTS
 BY: S.BERKOWITZ
 DRAWING #: PW9650-FPA-01
 SHEET: 4 OF 11

DP TABLES & GLASS TYPES
 NEWSOUTH WINDOW SOLUTIONS
 10741 CROSSROADS COMMERCE BLVD.
 TAMPA, FL 33610

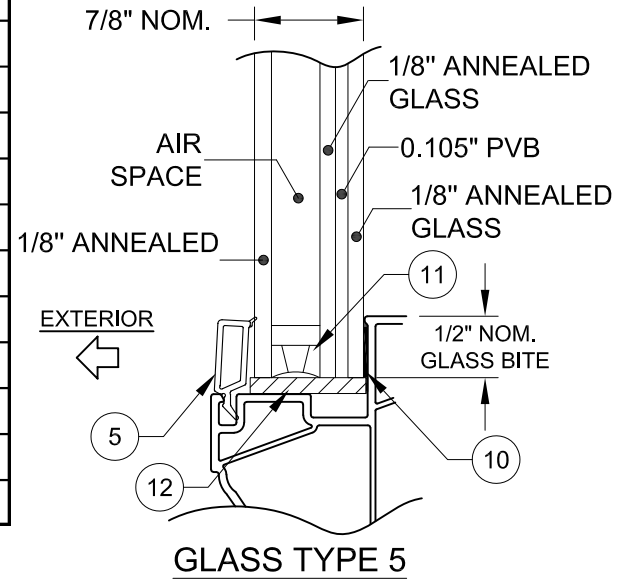

GLASS TYPE 5

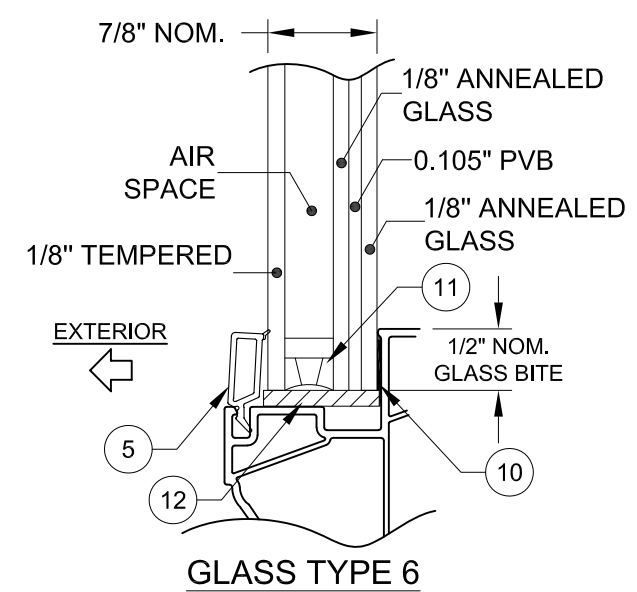

GLASS TYPE 6

TABLE E:

Window Design Pressure (+/- psf)																					
Glass Type 5: 7/8" LIG: (1/8" A - AIRSPACE - 5/16" A/A .105" PVB) Flange & Equal LEG Frames ONLY																					
WINDOW DIMENSIONS	Long Side (in.)																				
	41.5	42	44	46	48	50	52	54	56	58	60	62	64	66	68	70	72	74	76		
Short Side (in.)	18	85.0	85.0	85.0	85.0	85.0	85.0	85.0	85.0	85.0	85.0	85.0	85.0	85.0	85.0	85.0	85.0	85.0	85.0	85.0	
	20	85.0	85.0	85.0	85.0	85.0	85.0	85.0	85.0	85.0	85.0	85.0	85.0	85.0	85.0	85.0	85.0	85.0	85.0	85.0	
	22	85.0	85.0	85.0	85.0	85.0	85.0	85.0	85.0	85.0	85.0	85.0	85.0	85.0	85.0	85.0	85.0	85.0	85.0	85.0	
	24	85.0	85.0	85.0	85.0	85.0	85.0	85.0	85.0	85.0	85.0	85.0	85.0	85.0	85.0	85.0	85.0	84.4			
	26	85.0	85.0	85.0	85.0	85.0	85.0	85.0	85.0	85.0	85.0	85.0	85.0	85.0	84.9	81.9					
	28	85.0	85.0	85.0	85.0	85.0	85.0	85.0	85.0	85.0	85.0	85.0	85.0								
	30	85.0	85.0	85.0	85.0	85.0	85.0	85.0	85.0	85.0											
	32	85.0	85.0	85.0	85.0	85.0	85.0	85.0	85.0	84.9											
	34	85.0	85.0	85.0	85.0	85.0	85.0														
	36	85.0	85.0	85.0	85.0	85.0															
	38	85.0	85.0	85.0																	
	40	85.0	85.0																		
41.5	85.0																				

TABLE F:

Window Design Pressure (+/- psf)																					
Glass Type 6: 7/8" LIG: (1/8" T - AIRSPACE - 5/16" A/A .105" PVB) Flange & Equal Leg Frames ONLY																					
WINDOW DIMENSIONS	Long Side (in.)																				
	41.5	42	44	46	48	50	52	54	56	58	60	62	64	66	68	70	72	74	76		
Short Side (in.)	18	85.0	85.0	85.0	85.0	85.0	85.0	85.0	85.0	85.0	85.0	85.0	85.0	85.0	85.0	85.0	85.0	85.0	85.0	85.0	
	20	85.0	85.0	85.0	85.0	85.0	85.0	85.0	85.0	85.0	85.0	85.0	85.0	85.0	85.0	85.0	85.0	85.0	85.0	85.0	
	22	85.0	85.0	85.0	85.0	85.0	85.0	85.0	85.0	85.0	85.0	85.0	85.0	85.0	85.0	85.0	85.0	85.0	85.0	85.0	
	24	85.0	85.0	85.0	85.0	85.0	85.0	85.0	85.0	85.0	85.0	85.0	85.0	85.0	85.0	85.0	85.0	85.0			
	26	85.0	85.0	85.0	85.0	85.0	85.0	85.0	85.0	85.0	85.0	85.0	85.0	85.0	85.0						
	28	85.0	85.0	85.0	85.0	85.0	85.0	85.0	85.0	85.0	85.0	85.0									
	30	85.0	85.0	85.0	85.0	85.0	85.0	85.0	85.0	85.0											
	32	85.0	85.0	85.0	85.0	85.0	85.0	85.0	85.0	84.9											
	34	85.0	85.0	85.0	85.0	85.0	85.0														
	36	85.0	85.0	85.0	85.0	85.0															
	38	85.0	85.0	85.0																	
	40	85.0	85.0																		
41.5	85.0																				

NOTES: 1) FOR SIZES NOT SHOWN, ROUND UP TO THE NEXT AVAILABLE WIDTH OR HEIGHT DIMENSION.



A. LYNN MILLER, P.E., P.E.# 58705

TABLE G:

Window Design Pressure (+/- psf)																
Glass Type 7: 7/8" LIG: (3/16" A - AIRSPACE - 5/16" A/A .090 PVB)																
Glass Type 8: 7/8" LIG: (3/16" T - AIRSPACE - 5/16" A/A .090 PVB)																
WINDOW DIMENSIONS	Long Side (in.)															
	54	56	58	60	62	64	66	68	70	72	74	76	78	80	82	84
Short Side (in.)	30	70.0	70.0	70.0	70.0	70.0	70.0	70.0	70.0	70.0	70.0	70.0	70.0	70.0	70.0	70.0
	32	70.0	70.0	70.0	70.0	70.0	70.0	70.0	70.0	70.0	70.0	70.0	70.0	70.0		
	34	70.0	70.0	70.0	70.0	70.0	70.0	70.0	70.0	70.0	70.0	70.0				
	36	70.0	70.0	70.0	70.0	70.0	70.0	70.0	70.0	70.0						
	38	70.0	70.0	70.0	70.0	70.0	70.0	69.8	69.0							
	40	70.0	70.0	70.0	70.0	69.8	68.7									
	42	70.0	70.0	70.0	69.2											
	44	70.0	70.0	69.2												
	46	70.0	69.7													
48	70.0															

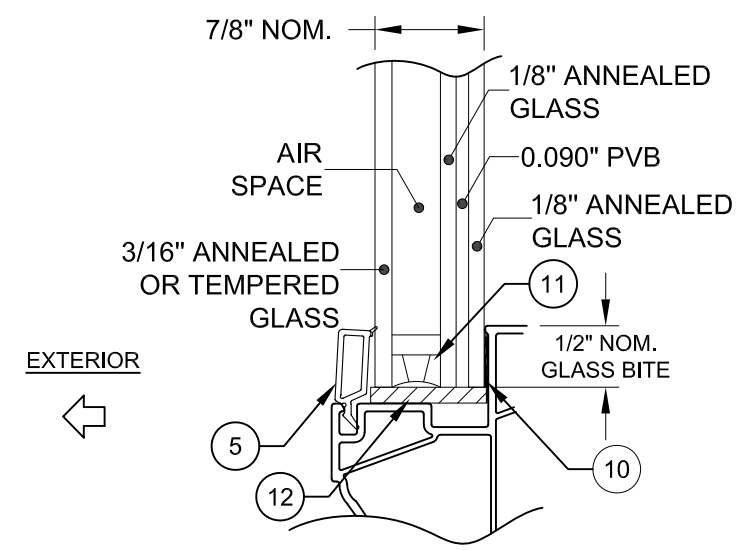

GLASS TYPE 7 (WITH ANNEALED CAP)
GLASS TYPE 8 (WITH TEMPERED CAP)

NOTES: 1) FOR SIZES NOT SHOWN, ROUND UP TO THE NEXT AVAILABLE WIDTH OR HEIGHT DIMENSION.

PREPARED BY: A. LYNN MILLER, P.E.
1070 TECHNOLOGY DR
N. VENICE, FL 34275
(941)-480-1600

REGISTRATION #29296
COPYRIGHT © 2022
NEWSOUTH WINDOW SOLUTIONS
LIMITED LICENSE TO MAKE
COPIES FOR PERMITTING

BY: FIXED WINDOW FPA, LM
SB
SB
DP TABLES & GLASS TYPES
NEWSOUTH WINDOW SOLUTIONS
10741 CROSSROADS COMMERCE BLVD.
TAMPA, FL 33610

#:	REVISION:	DATE:
B	REVISE SILICONE & ANCHOR OPTIONS, AND DP TABLES	11/28/22
C	CORRECT TYPO, TABLE 1 HEADER, ADD SHAPES, ADD SILICONE 995.	08/16/23

DATE: 02/01/23
SCALE: NTS
BY: S.BERKOWITZ
DRAWING #: PW9650-FPA-01
SHEET: 5 OF 11



A. LYNN MILLER, P.E., P.E.# 58705

REGISTRATION #29296
 COPYRIGHT © 2022
 NEWSOUTH WINDOW SOLUTIONS
 LIMITED LICENSE TO MAKE
 COPIES FOR PERMITTING

PREPARED BY: A. LYNN MILLER, P.E.
 1070 TECHNOLOGY DR
 N. VENICE, FL 34275
 (941)-480-1600

BY: **FIXED WINDOW FPA, LM**
 SB
 SB
 DP TABLES & GLASS TYPES
 NEWSOUTH WINDOW SOLUTIONS
 10741 CROSSROADS COMMERCE BLVD.
 TAMPA, FL 33610

REVISION:	REVISE SILICONE & ANCHOR OPTIONS, AND DP TABLES
DATE:	11/28/22
#:	B
REVISION:	CORRECT TYPO, TABLE 1 HEADER, ADD SHAPES, ADD SILICONE 995.
DATE:	08/16/23
#:	C

DATE: 02/01/23
 SCALE: NTS
 BY: S.BERKOWITZ
 DRAWING #: PW9650-FPA-01
 SHEET: 6 OF 11

TABLE H:

Window Design Pressure (+/- psf)																											
Glass Type 9: 7/8" LIG: (3/16" A - AIRSPACE - 5/16" A/A .090" SG)																											
WINDOW DIMENSIONS	Long Side (in.)																										
	70.875	72	74	76	78	80	82	84	86	88	90	92	94	96	98	100	102	104	106	108	110	112	114	116	118	120	
40	60.0	60.0	60.0	60.0	60.0	60.0	60.0	60.0	60.0	60.0	60.0	60.0	60.0	60.0	60.0	60.0	60.0	60.0	60.0	59.0	58.0	57.0	55.8	54.8	53.8	53.0	52.4
42	60.0	60.0	60.0	60.0	60.0	60.0	60.0	60.0	60.0	60.0	60.0	60.0	60.0	60.0	60.0	60.0	60.0	58.8	57.3	55.8	54.2	53.1	52.2	51.4	50.8	50.0	
44	60.0	60.0	60.0	60.0	60.0	60.0	60.0	60.0	60.0	60.0	60.0	60.0	60.0	60.0	60.0	60.0	59.9	58.0	56.3	54.7	53.2	52.1	51.1				
46	60.0	60.0	60.0	60.0	60.0	60.0	60.0	60.0	60.0	60.0	60.0	60.0	60.0	60.0	60.0	60.0	59.9	58.2	56.4	54.6							
48	60.0	60.0	60.0	60.0	60.0	60.0	60.0	60.0	60.0	60.0	60.0	60.0	60.0	60.0	60.0	59.8	58.4	57.5									
50	60.0	60.0	60.0	60.0	60.0	60.0	60.0	60.0	60.0	60.0	60.0	60.0	60.0	60.0	59.5	58.3											
52	60.0	60.0	60.0	60.0	60.0	60.0	60.0	60.0	60.0	60.0	60.0	60.0	60.0	58.8													
54	60.0	60.0	60.0	60.0	60.0	60.0	60.0	60.0	60.0	60.0	60.0	59.1															
56	60.0	60.0	60.0	60.0	60.0	60.0	60.0	60.0	60.0	60.0	58.6																
58	60.0	60.0	60.0	60.0	60.0	60.0	60.0	60.0	59.8																		
60	60.0	60.0	60.0	60.0	60.0	60.0	60.0	58.8																			
62	60.0	60.0	60.0	60.0	60.0	59.1																					
64	60.0	60.0	60.0	60.0	58.6																						
66	60.0	60.0	59.7	58.3																							
68	60.0	59.6	58.1																								
70	58.9	58.1																									
70.875	58.3																										

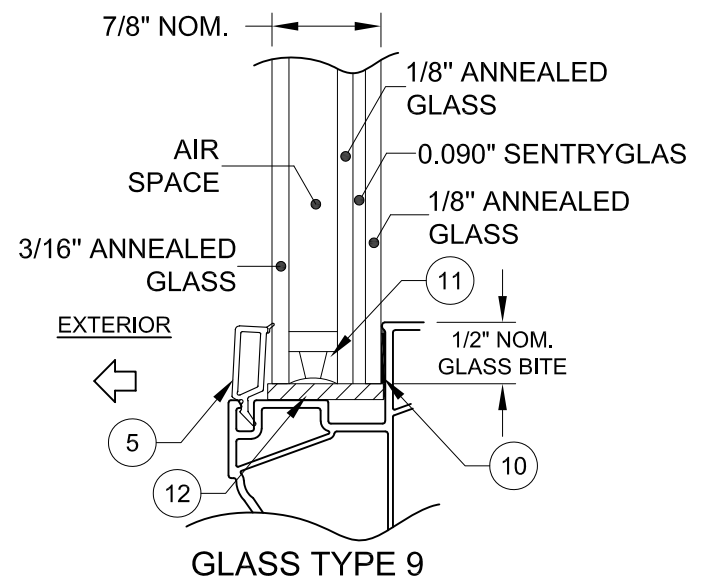

NOTES: 1) FOR SIZES NOT SHOWN, ROUND UP TO THE NEXT AVAILABLE WIDTH OR HEIGHT DIMENSION.

TABLE I

Window Design Pressure (+/- psf)																											
Glass Type 10: 7/8" LIG: (3/16" T- AIRSPACE - 5/16" A/A .090" SG)																											
WINDOW DIMENSIONS	Long Side (in.)																										
	70.875	72	74	76	78	80	82	84	86	88	90	92	94	96	98	100	102	104	106	108	110	112	114	116	118	120	
40	60.0	60.0	60.0	60.0	60.0	60.0	60.0	60.0	60.0	60.0	60.0	60.0	60.0	60.0	60.0	60.0	60.0	60.0	60.0	60.0	60.0	60.0	60.0	60.0	60.0	60.0	
42	60.0	60.0	60.0	60.0	60.0	60.0	60.0	60.0	60.0	60.0	60.0	60.0	60.0	60.0	60.0	60.0	60.0	60.0	60.0	60.0	60.0	60.0	60.0	60.0	60.0	60.0	60.0
44	60.0	60.0	60.0	60.0	60.0	60.0	60.0	60.0	60.0	60.0	60.0	60.0	60.0	60.0	60.0	60.0	60.0	60.0	60.0	60.0	60.0	60.0	60.0	60.0			
46	60.0	60.0	60.0	60.0	60.0	60.0	60.0	60.0	60.0	60.0	60.0	60.0	60.0	60.0	60.0	60.0	60.0	60.0	60.0	60.0	60.0						
48	60.0	60.0	60.0	60.0	60.0	60.0	60.0	60.0	60.0	60.0	60.0	60.0	60.0	60.0	60.0	60.0	60.0	60.0	60.0								
50	60.0	60.0	60.0	60.0	60.0	60.0	60.0	60.0	60.0	60.0	60.0	60.0	60.0	60.0	60.0	60.0											
52	60.0	60.0	60.0	60.0	60.0	60.0	60.0	60.0	60.0	60.0	60.0	60.0	60.0	60.0													
54	60.0	60.0	60.0	60.0	60.0	60.0	60.0	60.0	60.0	60.0	60.0	60.0															
56	60.0	60.0	60.0	60.0	60.0	60.0	60.0	60.0	60.0	60.0	60.0																
58	60.0	60.0	60.0	60.0	60.0	60.0	60.0	60.0	60.0																		
60	60.0	60.0	60.0	60.0	60.0	60.0	60.0	60.0																			
62	60.0	60.0	60.0	60.0	60.0	60.0																					
64	60.0	60.0	60.0	60.0	60.0																						
66	60.0	60.0	60.0	60.0																							
68	60.0	60.0	60.0																								
70	60.0	60.0																									
70.875	60.0																										



A. LYNN MILLER, P.E., P.E.# 58705

REGISTRATION #29296
 COPYRIGHT © 2022
 NEWSOUTH WINDOW SOLUTIONS
 LIMITED LICENSE TO MAKE
 COPIES FOR PERMITTING

PREPARED BY: A. LYNN MILLER, P.E.
 1070 TECHNOLOGY DR
 N. VENICE, FL 34275
 (941)-480-1600

BY: FIXED WINDOW FPA, LM
 SB
 SB
 DP TABLES & GLASS TYPES
 NEWSOUTH WINDOW SOLUTIONS
 10741 CROSSROADS COMMERCE BLVD.
 TAMPA, FL 33610

REVISION:	REVISE SILICONE & ANCHOR OPTIONS, AND DP TABLES
DATE:	11/28/22
#:	B
REVISION:	CORRECT TYPO, TABLE 1 HEADER, ADD SHAPES, ADD SILICONE 995.
DATE:	08/16/23
#:	C

DATE: 02/01/23
 SCALE: NTS
 BY: S.BERKOWITZ
 DRAWING #: PW9650-FPA-01
 SHEET: 7 OF 11

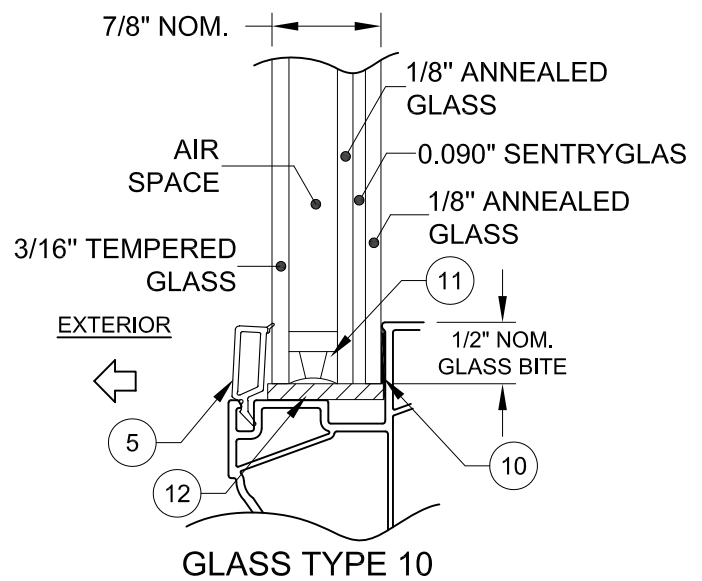

NOTES: 1) FOR SIZES NOT SHOWN, ROUND UP TO THE NEXT AVAILABLE WIDTH OR HEIGHT DIMENSION.



A. LYNN MILLER, P.E., P.E.# 58705

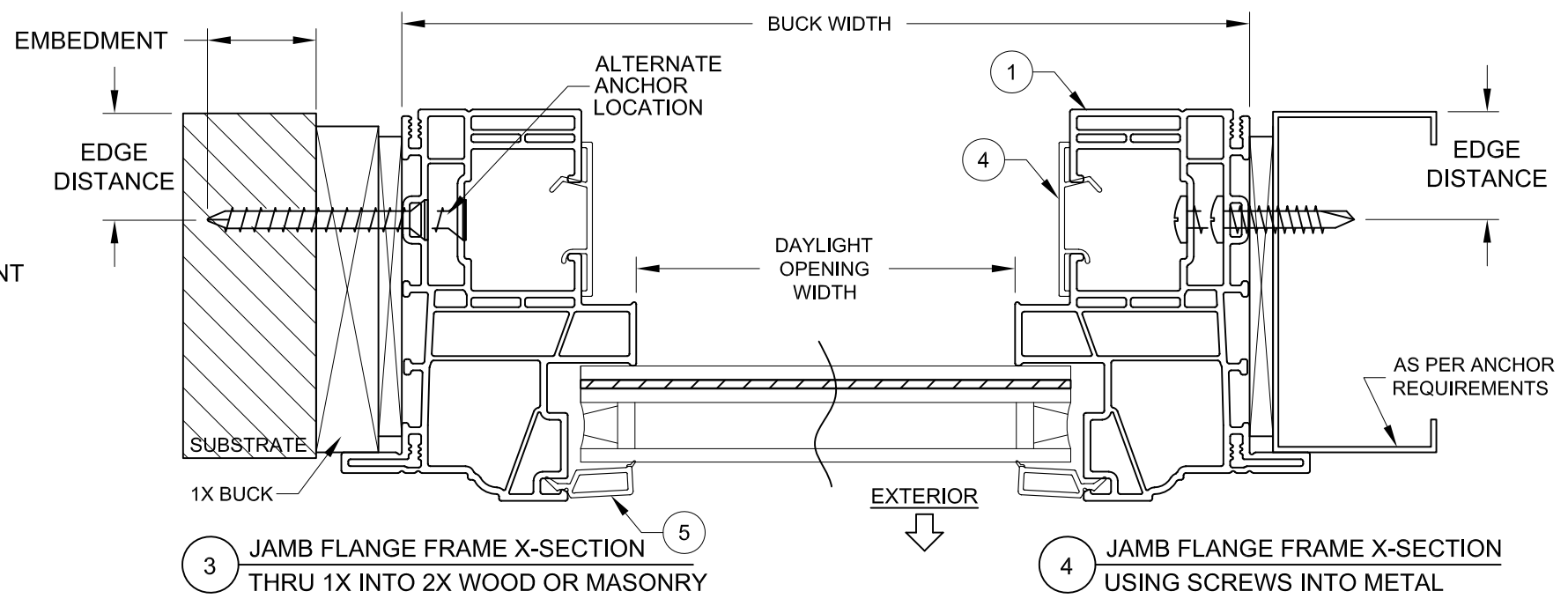
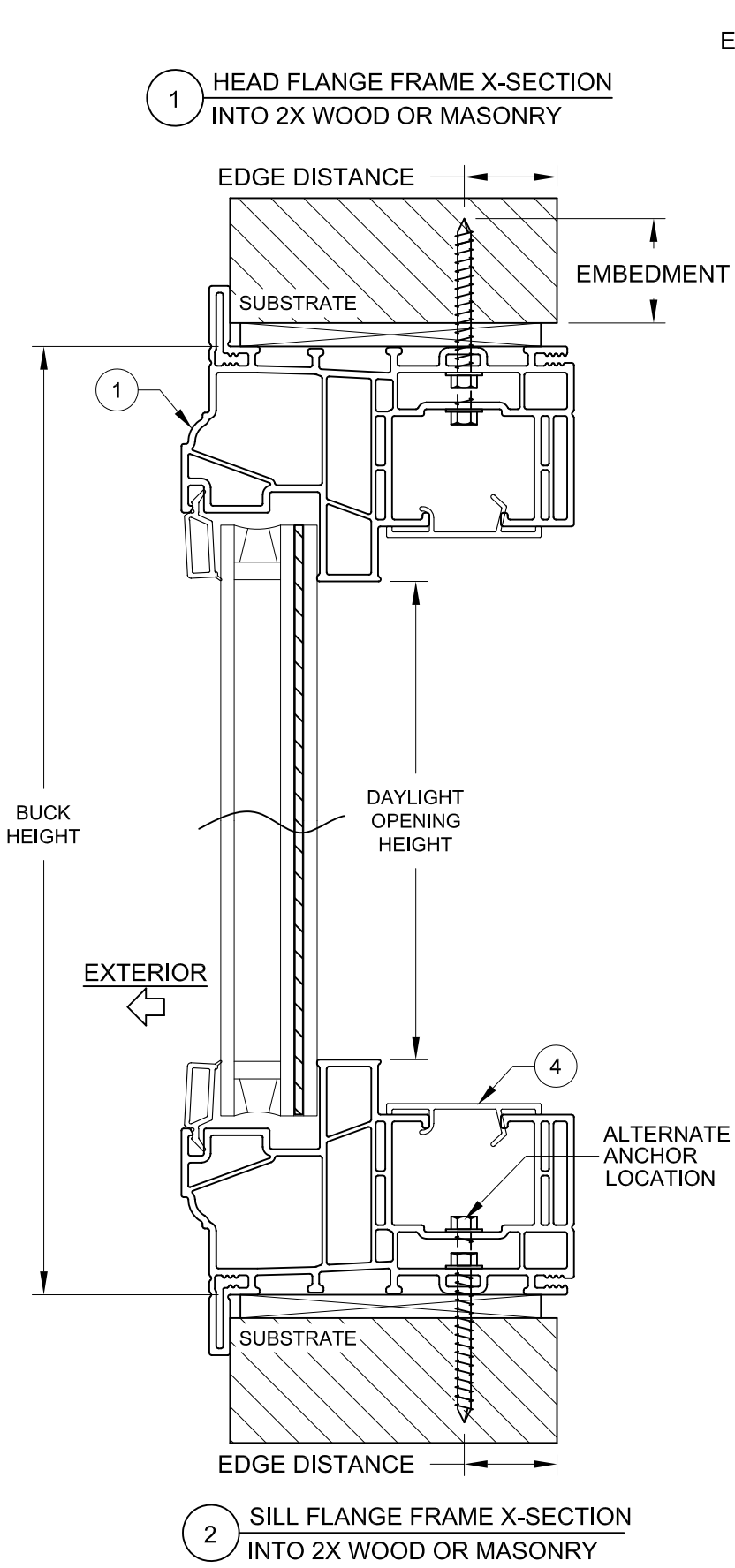

TABLE 2: INSTALLATION ANCHORS

Anchor	Substrate	Minimum Edge Distance	Minimum Embedment
#10 or #12 Steel or 410 SS Screw	Southern Pine (SG = .55)	9/16"	1-3/8"
	Aluminum, 6063-T5 min.	3/8"	0.050"
	Steel Stud, Gr. 33 min.	3/8"	0.045" (20 Ga)
	A36 Steel	3/8"	0.050"
3/16" Steel Ultracon+	Concrete (min. 2.9 ksi)	1"	1-3/4"
	UngROUTED CMU, (ASTM C-90)	1"	1-1/4"
	Southern Pine (SG = .55)	1"	1-3/8"
1/4" Steel Ultracon+	Concrete (min. 3.0 ksi)	1"	1-3/8"
	UngROUTED CMU, (ASTM C-90)	1"	1-1/4"
	Southern Pine (SG = .55)	1"	1-3/8"

- 1) ANCHOR MUST EXTEND A MINIMUM OF 3 THREADS BEYOND ANY METAL SUBSTRATE.
- 2) "UNGROUTED CMU" VALUES MAY BE USED FOR GROUDED CMU APPLICATIONS.
- 3) ALL ANCHOR HEAD TYPES ARE APPLICABLE.

INSTALLATION NOTES:

- 1) SEE SHEET 1 FOR ANCHOR SPACING REQUIREMENTS.
- 2) ANY INSTALLATION OPTION SHOWN (2X BUCK, 1X BUCK, DIRECT TO MASONRY, STEEL STUD) MAY BE USED ON ANY SIDE OF THE WINDOW.
- 3) USE ONLY SUBSTRATE APPROPRIATE ANCHORS LISTED IN ANCHOR TABLE. FOLLOW EMBEDMENT AND EDGE DISTANCE LIMITS. MAX. SHIM THICKNESS TO BE 1/4". ANY INSTALLATION OPTION SHOWN MAY BE USED ON ANY OR ALL SIDES OF THE WINDOW.

REGISTRATION #29296
 COPYRIGHT © 2022
 NEWSOUTH WINDOW SOLUTIONS
 LIMITED LICENSE TO MAKE
 COPIES FOR PERMITTING

PREPARED BY: A. LYNN MILLER, P.E.
 1070 TECHNOLOGY DR
 N. VENICE, FL 34275
 (941)-480-1600

BY:	FIXED WINDOW FPA, LM
REVISION:	REVISE SILICONE & ANCHOR OPTIONS, AND DP TABLES
DATE:	11/28/22
#:	B
DATE:	08/16/23
#:	C
DATE:	02/01/23
SCALE:	NTS
BY:	S.BERKOWITZ
DRAWING #:	PW9650-FPA-01
SHEET:	8 OF 11

FLANGE INSTALLATION SECTION VIEWS
 NEWSOUTH WINDOW SOLUTIONS
 10741 CROSSROADS COMMERCE BLVD.
 TAMPA, FL 33610



A. LYNN MILLER, P.E.; P.E.# 58705

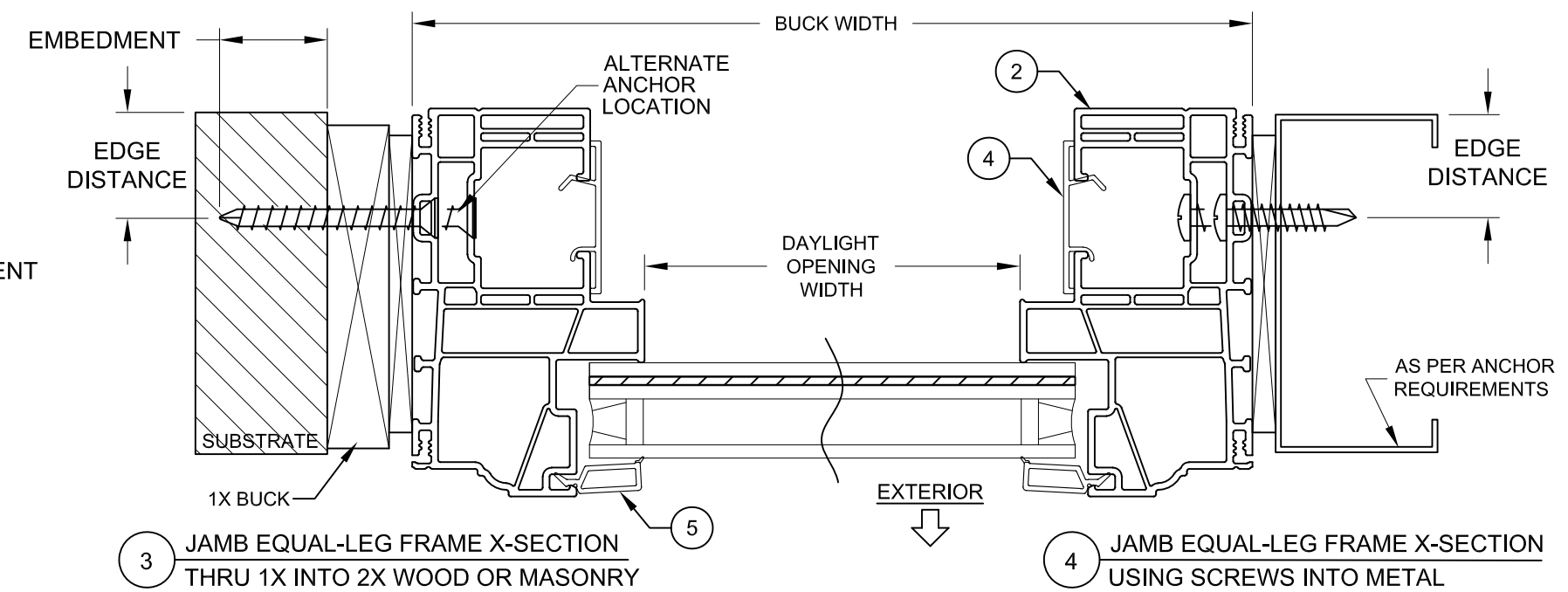
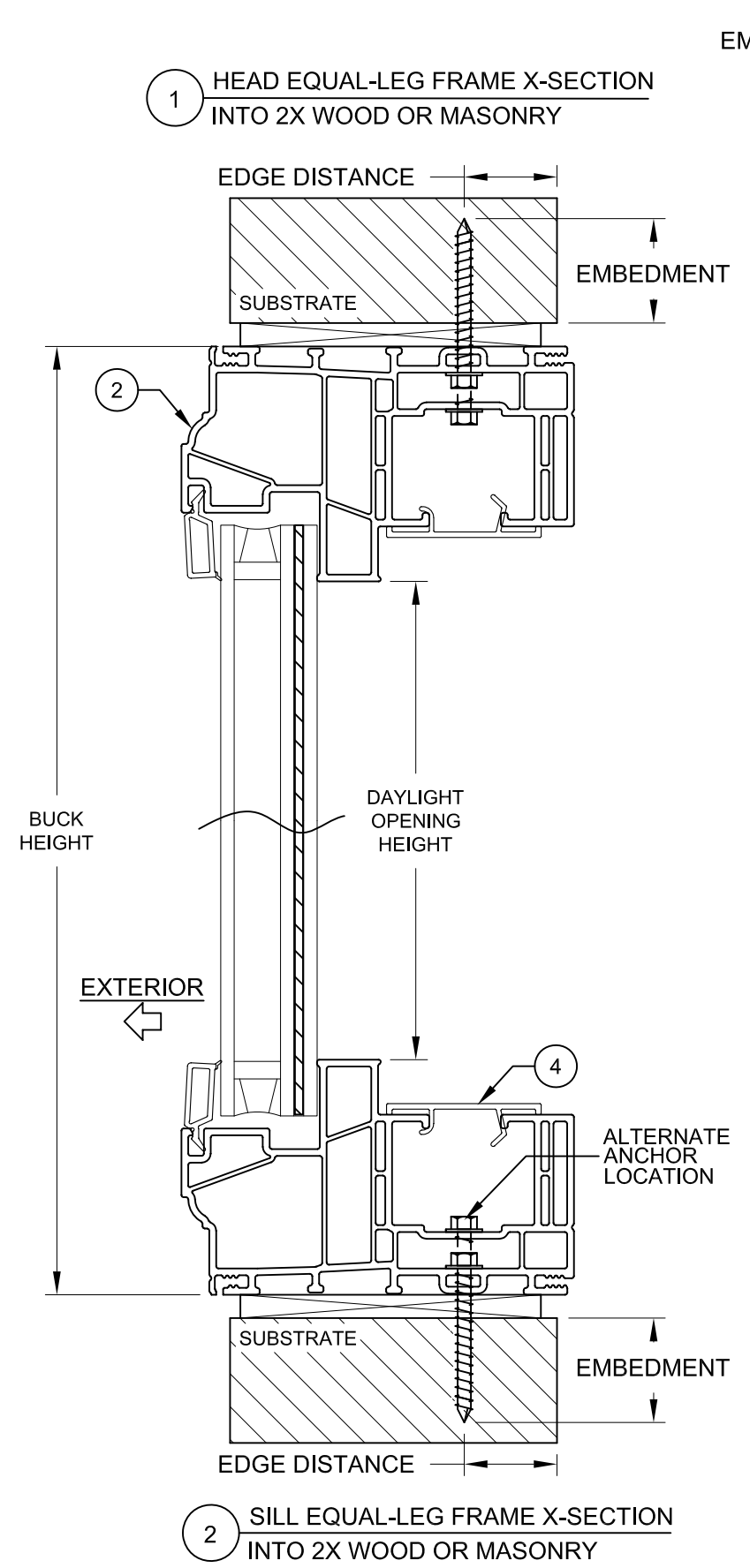

TABLE 3: INSTALLATION ANCHORS

Anchor	Substrate	Minimum Edge Distance	Minimum Embedment
#10 or #12 Steel or 410 SS Screw	Southern Pine (SG = .55)	9/16"	1-3/8"
	Aluminum, 6063-T5 min.	3/8"	0.050"
	Steel Stud, Gr. 33 min.	3/8"	0.045" (20 Ga)
	A36 Steel	3/8"	0.050"
3/16" Steel Ultracon+	Concrete (min. 2.9 ksi)	1"	1-3/4"
	UngROUTED CMU, (ASTM C-90)	1"	1-1/4"
	Southern Pine (SG = .55)	1"	1-3/8"
1/4" Steel Ultracon+	Concrete (min. 3.0 ksi)	1"	1-3/8"
	UngROUTED CMU, (ASTM C-90)	1"	1-1/4"
	Southern Pine (SG = .55)	1"	1-3/8"

1) ANCHOR MUST EXTEND A MINIMUM OF 3 THREADS BEYOND ANY METAL SUBSTRATE.
 2) "UNGROUTED CMU" VALUES MAY BE USED FOR GROUDED CMU APPLICATIONS.
 3) ALL ANCHOR HEAD TYPES ARE APPLICABLE.

INSTALLATION NOTES:

- 1) SEE SHEET 1 FOR ANCHOR SPACING REQUIREMENTS.
- 2) ANY INSTALLATION OPTION SHOWN (2X BUCK, 1X BUCK, DIRECT TO MASONRY, STEEL STUD) MAY BE USED ON ANY SIDE OF THE WINDOW.
- 3) USE ONLY SUBSTRATE APPROPRIATE ANCHORS LISTED IN ANCHOR TABLE. FOLLOW EMBEDMENT AND EDGE DISTANCE LIMITS. MAX. SHIM THICKNESS TO BE 1/4". ANY INSTALLATION OPTION SHOWN MAY BE USED ON ANY OR ALL SIDES OF THE WINDOW.

REGISTRATION #29296
 COPYRIGHT © 2022
 NEWSOUTH WINDOW SOLUTIONS
 LIMITED LICENSE TO MAKE
 COPIES FOR PERMITTING

PREPARED BY: A. LYNN MILLER, P.E.
 1070 TECHNOLOGY DR
 N. VENICE, FL 34275
 (941)-480-1600

BY:	FIXED WINDOW FPA, LM
REVISION:	EQUAL-LEG INSTALLATION SECTION VIEWS
DATE:	NEWSOUTH WINDOW SOLUTIONS 10741 CROSSROADS COMMERCE BLVD. TAMPA, FL 33610
#:	B C
DATE:	02/01/23
SCALE:	NTS
BY:	S.BERKOWITZ
DRAWING #:	PW9650-FPA-01
SHEET:	9 OF 11



A. LYNN MILLER, P.E., P.E.# 58705

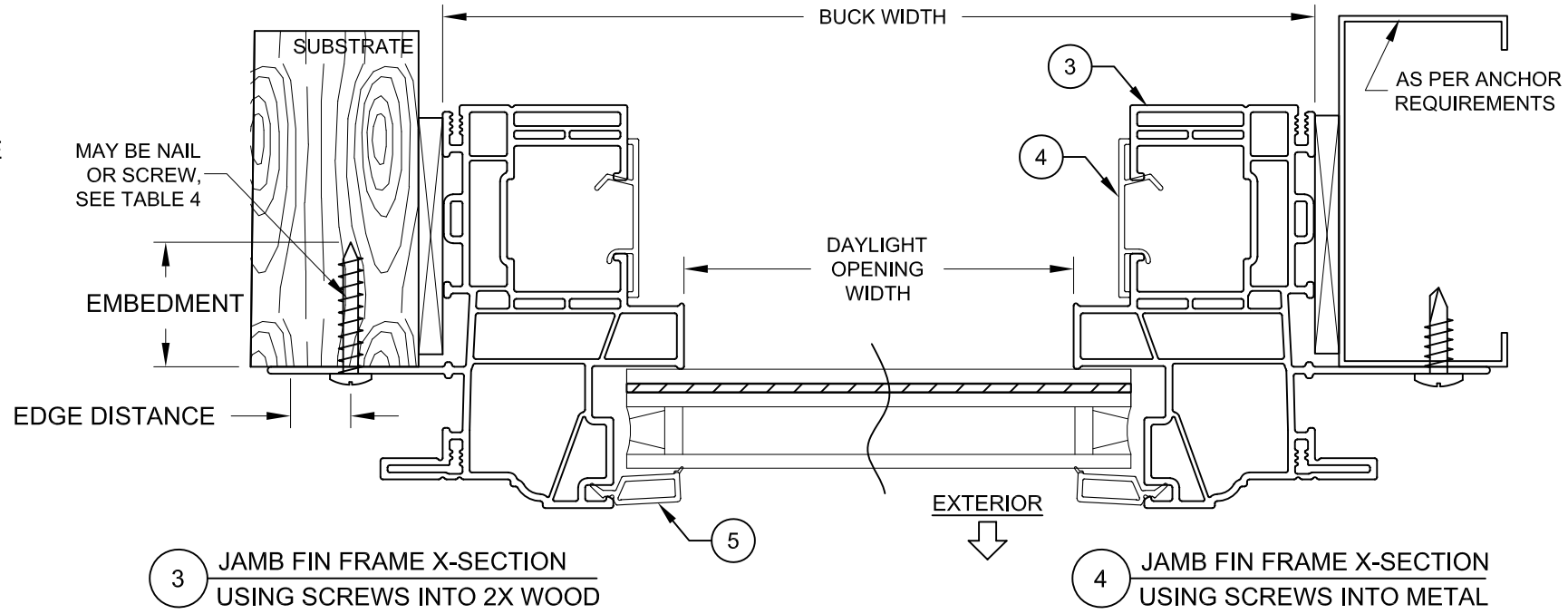
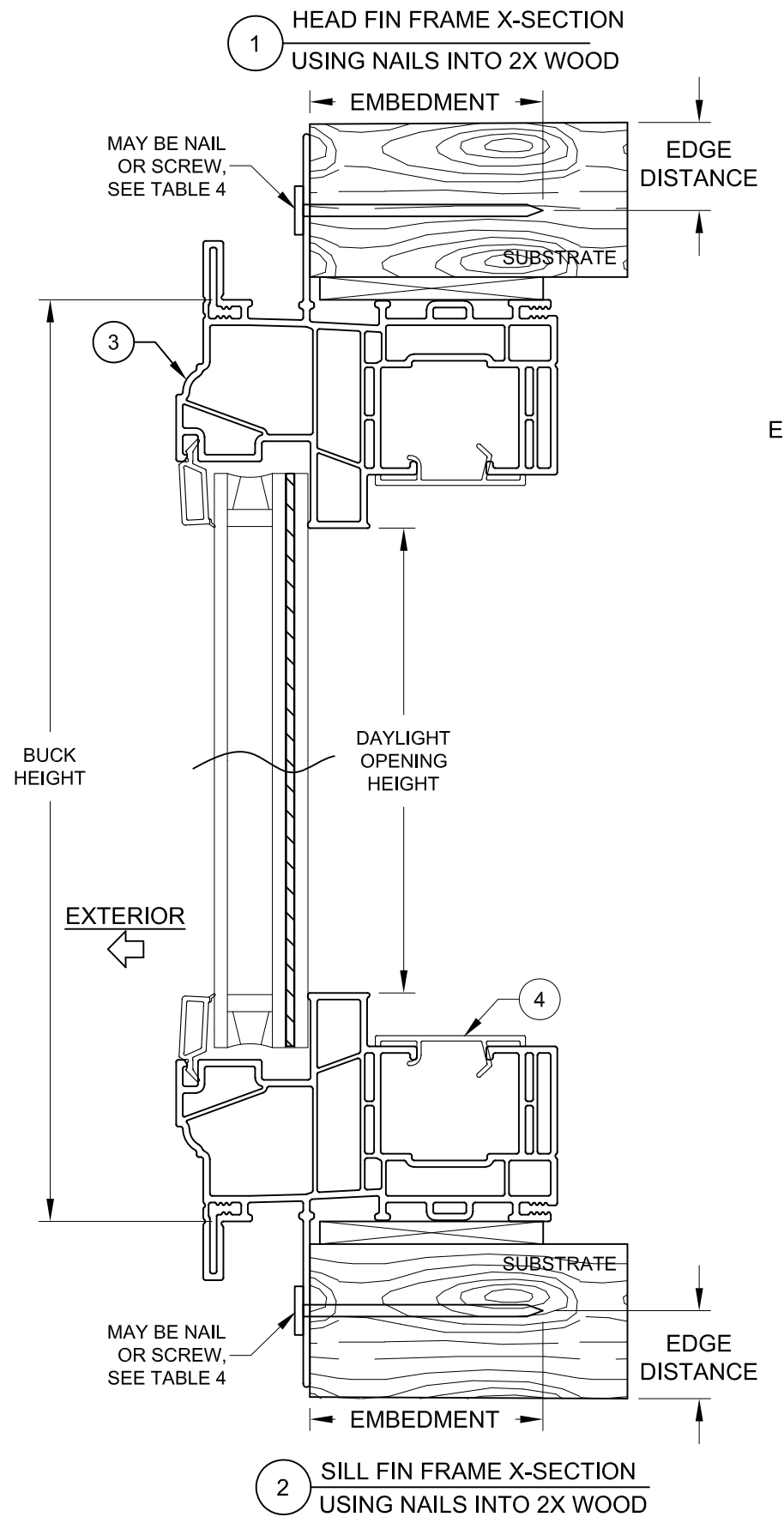

TABLE 4: INSTALLATION ANCHORS

Anchor	Substrate	Min. Edge Distance	Min. Embedment
2-1/2" x .113" Box Nail	P.T. Southern Pine (SG = .55)	5/16"	2-7/16"
2-1/2" x .131" Common Nail	P.T. Southern Pine (SG = .55)	3/8"	2-7/16"
2-1/2" x .145" Roofing Nail	P.T. Southern Pine (SG = .55)	3/8"	2-7/16"
#10 Steel SMS	P.T. Southern Pine (SG = .55)	1/2"	1-3/8"
	Aluminum, 6063-T5 min.	3/8"	1/8"
	Steel Stud, Gr. 33 min.	3/8"	0.036
	A36 Steel	3/8"	1/8"

1) ANCHOR MUST EXTEND A MINIMUM OF 3 THREADS BEYOND ANY METAL SUBSTRATE.
 2) ALL ANCHOR HEAD TYPES ARE APPLICABLE.

INSTALLATION NOTES:

- 1) SEE SHEET 1 FOR SPACING REQUIREMENTS.
- 2) FLANGE AND/OR FIN MAY BE REMOVED TO CREATE OTHER APPROVED FRAME TYPE.
- 3) USE ONLY SUBSTRATE APPROPRIATE ANCHORS LISTED IN ANCHOR TABLE. FOLLOW EMBEDMENT AND EDGE DISTANCE LIMITS. ANY INSTALLATION OPTION SHOWN MAY BE USED ON ANY OR ALL SIDES OF THE WINDOW.
- 4) MAX. SHIM THICKNESS TO BE 1/4". MAX. SHIM SPACING TO BE 18".

REGISTRATION #29296
 COPYRIGHT © 2022
 NEWSOUTH WINDOW SOLUTIONS
 LIMITED LICENSE TO MAKE
 COPIES FOR PERMITTING

PREPARED BY: A. LYNN MILLER, P.E.
 1070 TECHNOLOGY DR
 N. VENICE, FL 34275
 (941)-480-1600

BY:	FIXED WINDOW FPA, LM
REVISION:	REVISE SILICONE & ANCHOR OPTIONS, AND DP TABLES CORRECT TYPO, TABLE 1 HEADER, ADD SHAPES, ADD SILICONE 995.
DATE:	11/28/22
#:	B C
DATE:	02/01/23
SCALE:	NTS
BY:	S.BERKOWITZ
DRAWING #:	PW9650-FPA-01
SHEET:	10 OF 11

FIN INSTALLATION SECTION VIEWS
 NEWSOUTH WINDOW SOLUTIONS
 10741 CROSSROADS COMMERCE BLVD.
 TAMPA, FL 33610

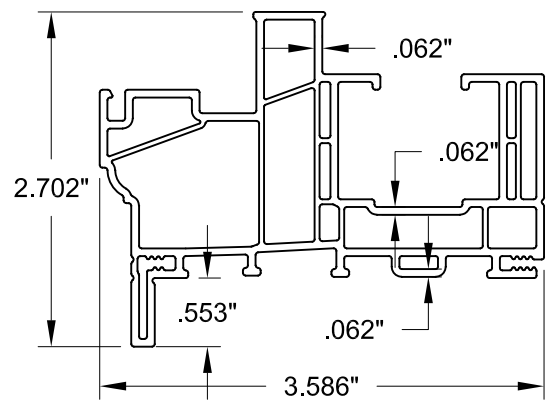

① FRAME, W/FLANGE

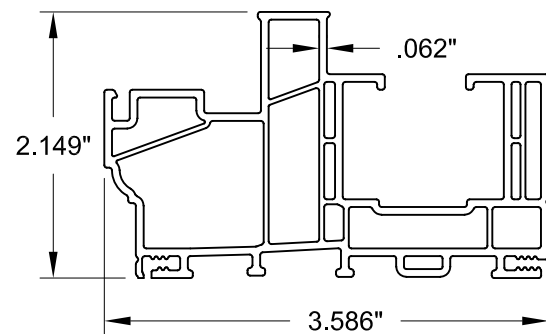

② FRAME, EQUAL LEG

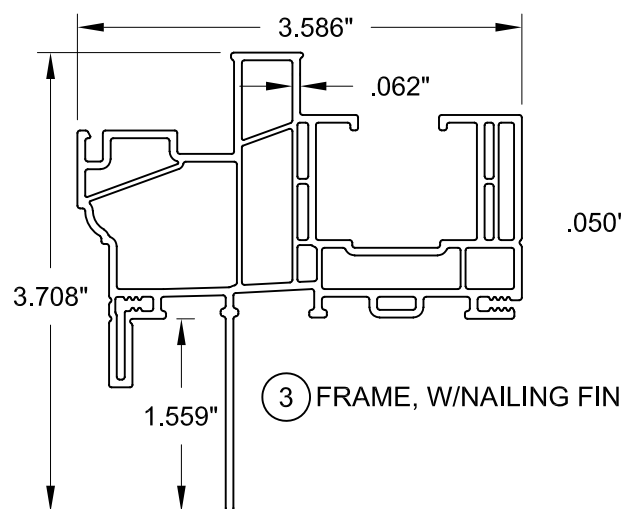

③ FRAME, W/NAILING FIN

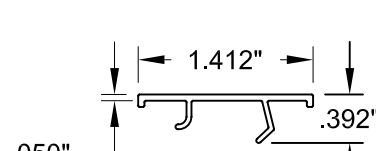

④ ANCHOR COVER

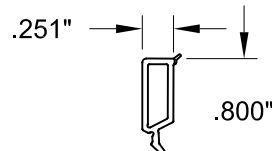

⑤ GLAZING BEAD

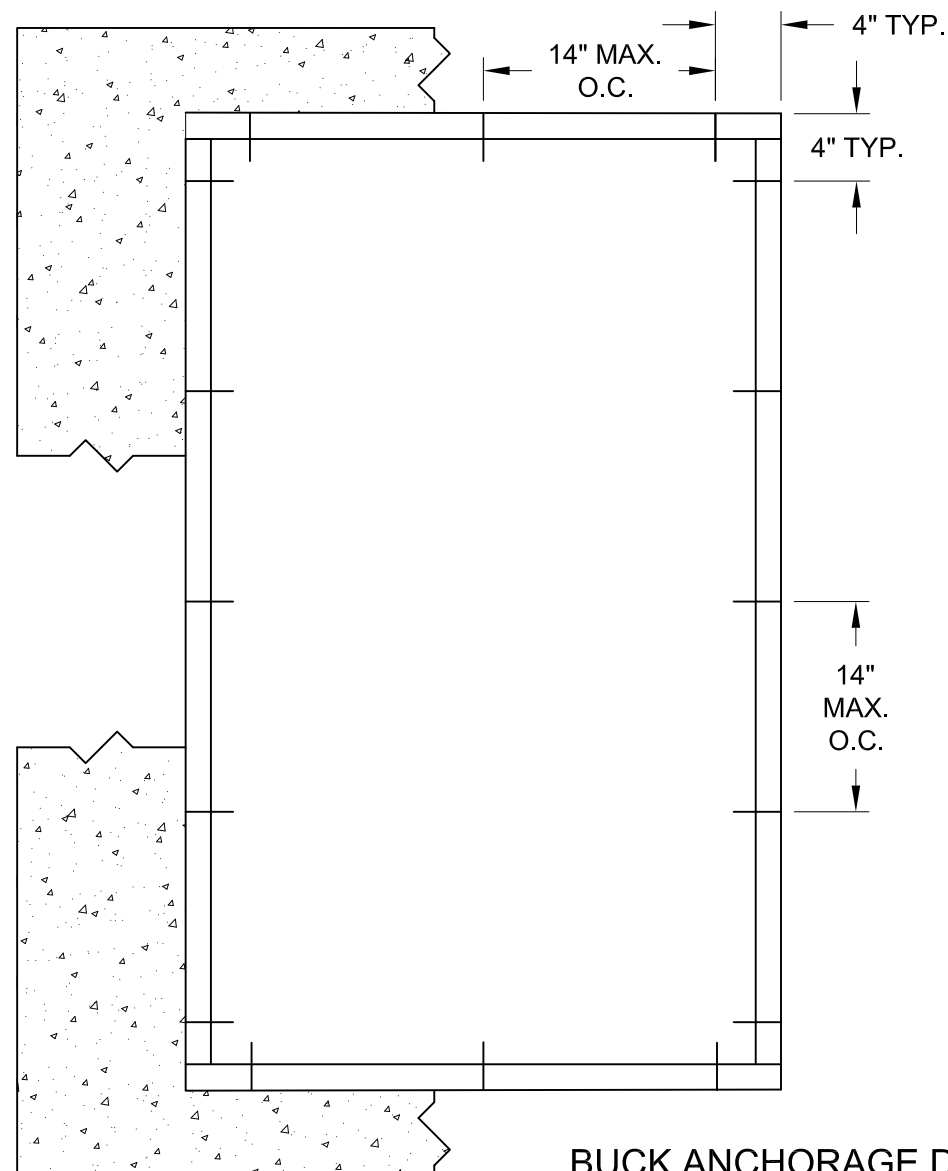

BUCK ANCHORAGE DETAIL

TABLE 5:

#	Part #	Description	Material
1	9465	Frame, w/Flange	PVC
2	9465	Frame, Equal Leg	PVC
3	9455	Frame, w/Nailing Fin	PVC
4	9473	Anchor Cover	PVC
5	9736	Glazing Bead	PVC
10		Glazing compound: RGS7700, Dow 791, 983, 995	
11		Metal or TPS Spacer	VARIABLES
12	7061	Setting Block, 1/8" x 7/8" x 2"	EPDM

THE APPROVED WHITE, RIGID PVC EXTERIOR EXTRUSIONS ARE TO BE PRODUCED BY EXTRUDERS' LICENSEES UNDER "AAMA CERTIFICATION PROGRAMS FOR RIGID PVC EXTRUSIONS".

TABLE 6:

Anchor	Substrate	Minimum Edge Distance	Minimum Embedment
1/4" Steel Ultracon+	Concrete (min. 3.0 ksi)	1"	1-3/8"
	UngROUTED CMU, (ASTM C-90)	1"	1-1/4"

1) "UNGROUTED CMU" VALUES MAY BE USED FOR GROUDED CMU APPLICATIONS.

2) ALL ANCHOR HEAD TYPES ARE APPLICABLE.



A. LYNN MILLER, P.E., P.E.# 58705

PREPARED BY: A. LYNN MILLER, P.E.
1070 TECHNOLOGY DR
N. VENICE, FL 34275
(941)-480-1600

REGISTRATION #29296
COPYRIGHT © 2022
NEWSOUTH WINDOW SOLUTIONS
LIMITED LICENSE TO MAKE
COPIES FOR PERMITTING

BY: FIXED WINDOW FPA, LM
SB BMATERIALS/EXTRUSIONS/BOM
SB BUCK INSTALLATION DETAILS
NEWSOUTH WINDOW SOLUTIONS
10741 CROSSROADS COMMERCE BLVD.
TAMPA, FL 33610

REVISION:	DATE:	#:
REVISE SILICONE & ANCHOR OPTIONS, AND DP TABLES	11/28/22	B
CORRECT TYPO, TABLE 1 HEADER, ADD SHAPES, ADD SILICONE 995.	08/16/23	C

DATE: 02/01/23
SCALE: NTS
BY: S.BERKOWITZ
DRAWING #: PW9650-FPA-01
SHEET: 11 OF 11